

3015 Wipe-On

Primary Applicator

Model 3015

The **Label-Aire® Model 3015 Wipe-On Primary Applicator** is an affordable wipe-on labeler that's easy to use and even easier on your bottom line.

The Model 3015 Wipe-On labeler delivers on its promise of speed, accuracy, ease of use, and affordability. The results are lower operating costs and increased productivity for your business.

The Label-Aire Model 3015 was designed for simple wipe-on labeling applications in all markets (available in either 220 Volts, 50 Hz or 115 Volts, 60 Hz configurations). But don't let its simplicity fool you. The 3015 comes with many standard features that provide an exceptional value for your money. Not only can the 3015 be easily converted to left- or right-hand use, it can also apply labels to the top, side, or bottom of products.

Put this affordable wipe-on pressure-sensitive technology to work for you all day, every day. Like every machine we make, the Model 3015 Wipe-On is built to Label-Aire's meticulous quality standards.



3015 Wipe-On Features	
Stepper motor drive	For precise starting / stopping, increased reliability, wider range speed variability, and lower maintenance.
Microprocessor controlled	Repeatable settings and constant monitoring ensures reliable operation.
Automatic Speed Following (ASF)	Labels are accurately applied even through extreme changes in product line speed.
Added versatility	Applies labels to the top, side, or bottom of products.
Wipe-on applicator	Label dispense accuracy up to $\pm .8$ mm (1/32").
Configuration	Easy conversion to left- or right-hand use.

beverage, cd / dvd, coupon / promotional, dairy, direct mail, durable goods, food, health & beauty, nutraceutical, pharmaceutical, tamper-evident labeling

3015

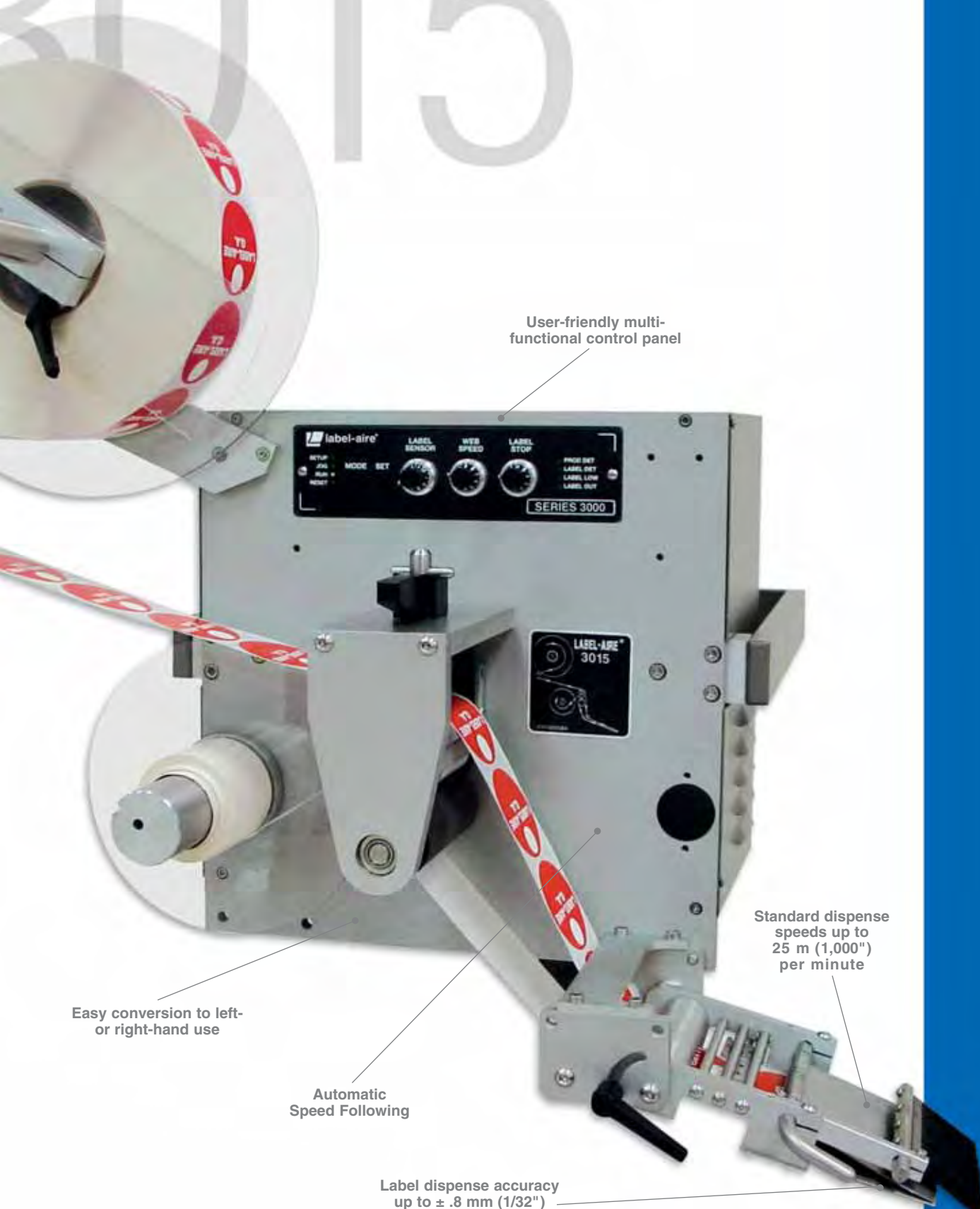

User-friendly multi-functional control panel



Standard dispense speeds up to 25 m (1,000") per minute

Easy conversion to left- or right-hand use

Automatic Speed Following

Label dispense accuracy up to $\pm .8$ mm (1/32")

3015 Wipe-On Specifications

Dimensions:

Height: 666.1 mm (26.22")
 Length: 702.5 mm (27.66")
 Width: 353 mm (13.9")

Weight:

36.3 kg (80 lbs.)

Standard Label Dimensions:

Max. Web Width: 101.6 mm (4")
 standard, 152.4 mm (6") optional
 Min. Web Width: 25.4 mm (1")
 Min. Label Length: 13 mm (.5")
 Max. Label Length: 304.8 mm (12")

Label Packaging:

305 mm (12") O.D. rolls std. on
 76 mm (3") I.D. cores

Dispense Speed:

Up to 25 m (1,000") of web
 per minute

Label Dispense Accuracy:

Up to +/- .8 mm (1/32")

Electrical:

220 Volts AC 50 Hz
 115 Volts AC 60 Hz 3 Amps. optional

Air (as needed):

2 cfm at 60 psi to 90 psi when
 imprinter is used

Options:

152 mm (6") label core adapter
 Encoder kit for Automatic
 Speed Following
 Strobe signals for "low label" and
 "out of labels"
 Clear label sensor upgrade
 Model 2600 T-Base stand

Consult factory for additional options.

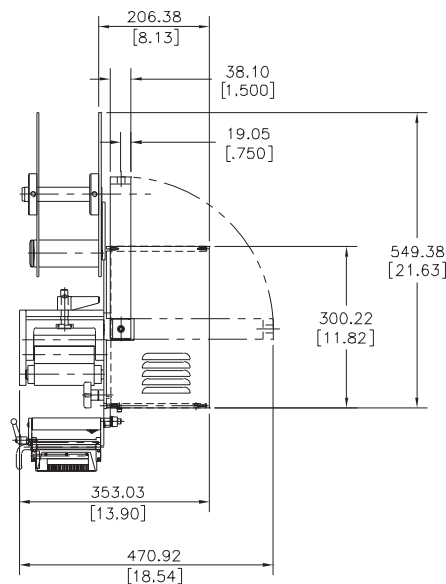
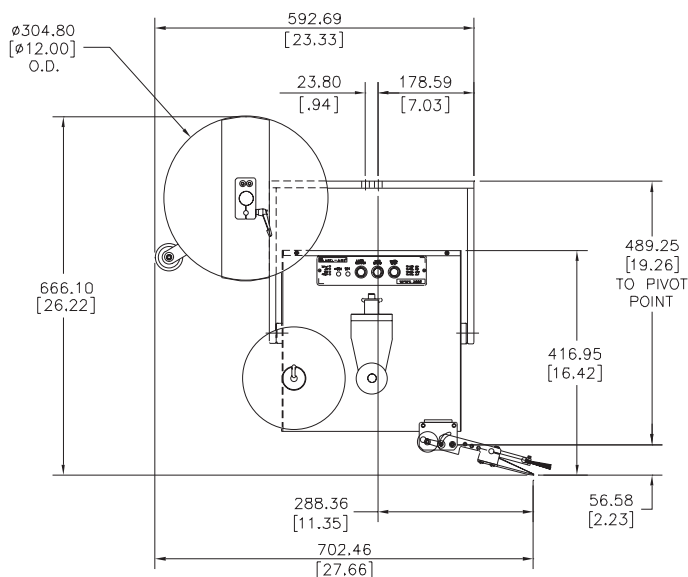

millimeters
[Inches]

Distributed by:



Headquarters

550 Burning Tree Road
 Fullerton, CA 92833 USA

o 714.441.0700
 f 714.526.0300
 e info@label-aire.com
 w www.label-aire.com

Europe

Sjællandsvej 27A
 DK-9500 Hobro, Denmark

o +45 9657 0063
 f +45 9657 0064
 e info@label-aire-as.com
 w www.label-aire-as.com