

CLV 420/421/422 Bar Code Scanner

Standard Line

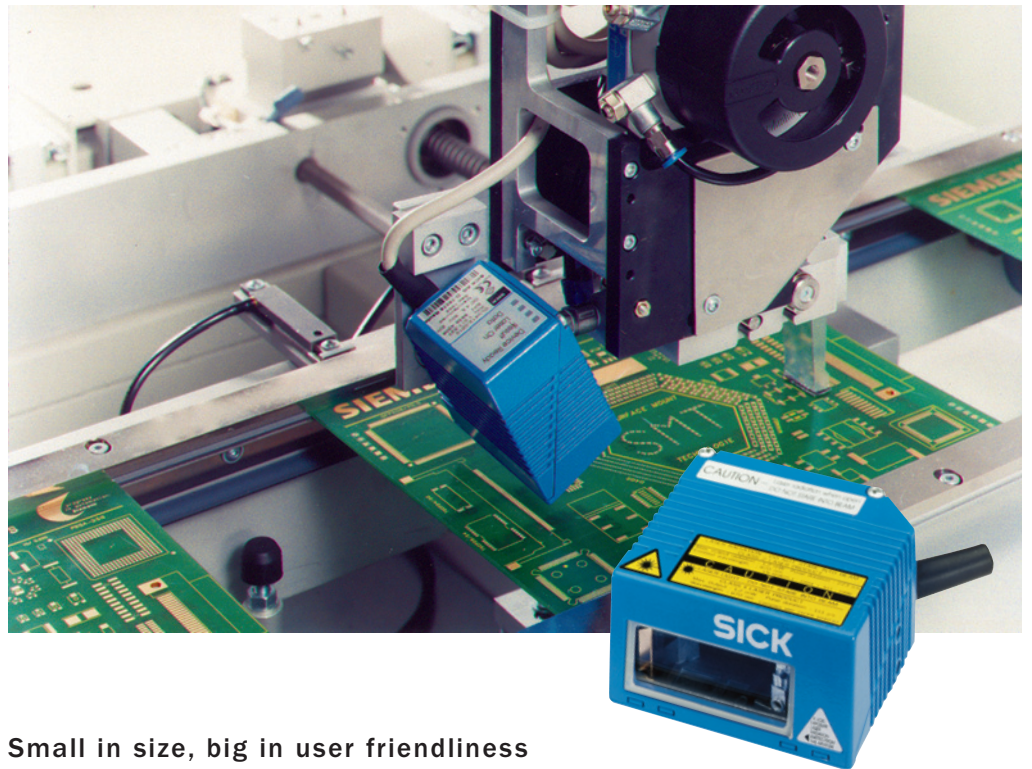

Small in size, big in user friendliness

The CLV 420 product family represents the logical development of miniature bar code readers. High reading performances and excellent user friendliness are united in a very small housing. Bar code identification in the case of very high conveyor velocities can also be realised, due to the extraordinary fast scan frequencies.

The CAN and the diagnosis interface, together with the well-established Windows Setup Software, offer the best in user friendliness for its class. Of course, the innovative adjustment tools, such as Auto Setup and automatic trigger have also been integrated.

Your benefit:

- Code identification even in the case of high conveyor velocities
- Easy setup procedures supported by state-of-the-art software tools
- Various possibilities for diagnosis
- Easy and simple connectivity

CLV 420/421/422 at a glance:

- High scan frequency of 1200 Hz
- Small housing
- Standard Range, Long Range and High Density Version available
- Angle attachment optional
- Flash memory for firmware
- CAN bus compatible

SICK

Reading diagrams

Line/Raster Scanner

CLV 420 STANDARD RANGE

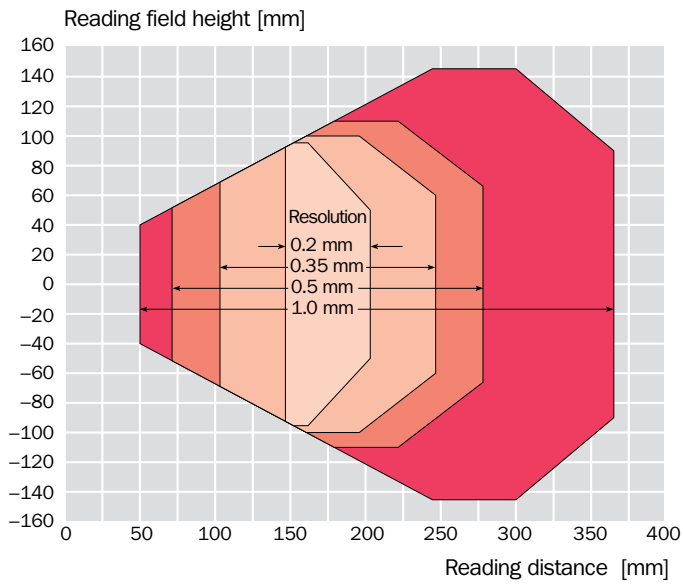

CLV 422 HIGH DENSITY

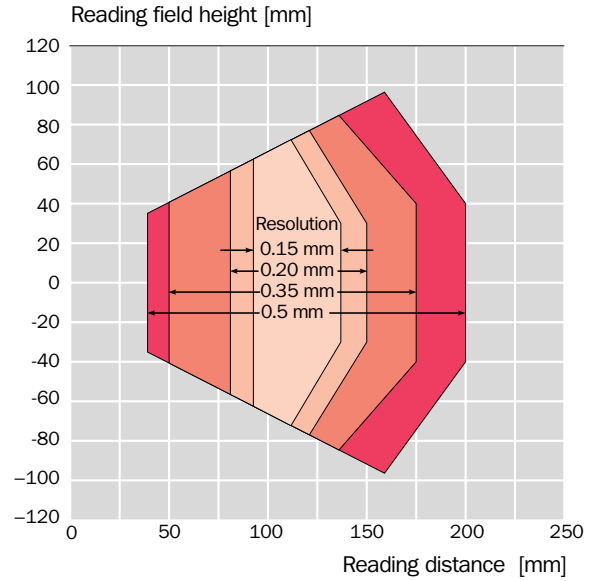

CLV 421 LONG RANGE

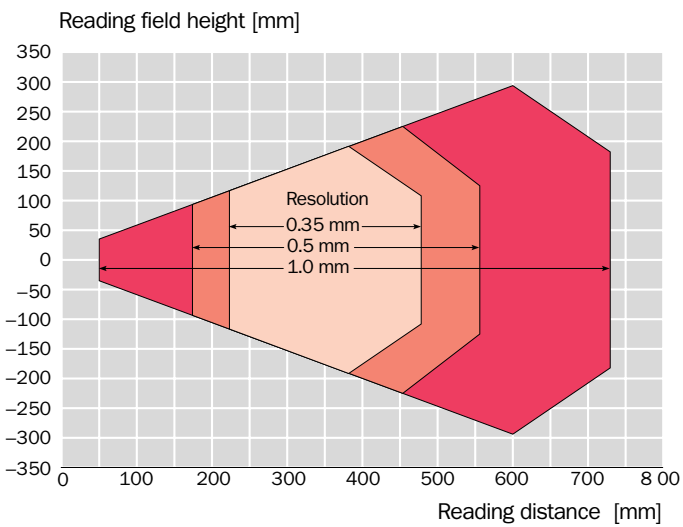

FRONT READING WINDOW

- CLV 420-0010
- CLV 420-1010
- CLV 421-0010
- CLV 421-1010
- CLV 422-0010
- CLV 422-1010

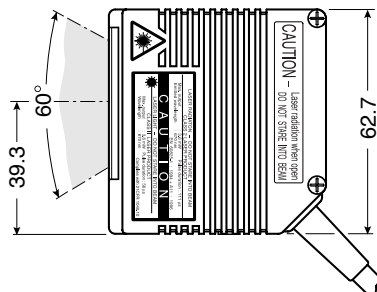
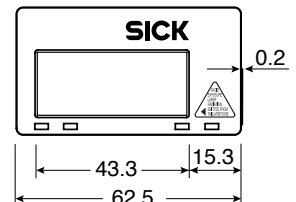
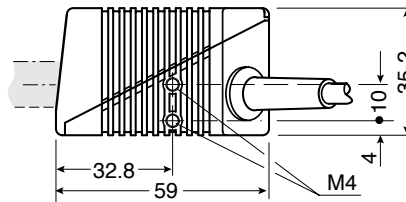
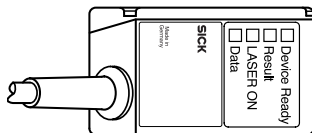

All dimensions in mm

Technical data line/raster scanner

Type	CLV 420 (Std. Range)	CLV 421 (Long Range)	CLV 422 (High Density)
Line scanner	CLV 420-0010/Order No. 1 022 031	CLV 421-0010/Order No. 1 022 547	CLV 422-0010/Order No. 1 022 548
Raster scanner	CLV 420-1010/Order No. 1 022 032	CLV 421-1010/Order No. 1 022 616	CLV 422-1010/Order No. 1 022 619
Line scanner with 105° angle att.	CLV 420-2010/Order No. 1 022 033	CLV 421-2010/Order No. 1 022 617	CLV 422-2010/Order No. 1 022 620
Raster scanner with 105° angle att.	CLV 420-3010/Order No. 1 022 034	CLV 421-3010/Order No. 1 022 618	CLV 422-3010/Order No. 1 022 621
Focus	Fixed focus		
Reading window	Line/raster scanner: front Line/raster scanner with angle attachment: side (angle of emergence 105°)		
Laser diode (wavelength)	red light ($\lambda = 650 - 670$ nm)		
MTBF of laser diode	20,000 h		
Laser class	Class 2 (pursuant to DIN EN 60825-1)		
Useful aperture angle	max. 50°		
Scanning/decoding frequency	400 ... 1200 Hz		
Resolution	0.15 ... 1.0 mm		
Raster height	15 mm (8 lines) at a reading distance of 200 mm (front reading window)		
Bar code print contrast (PCS)	≥ 60 %		
Immunity to ambient light	2000 lx (on bar code)		
No. of bar codes per scan	1 ... 3		
No. of bar codes per reading interval	1 ... 10		
Bar code types	Code 39, Code 128, Code 93, Codabar, EAN, EAN 128, UPC, 2/5 Interleaved		
Bar code length	max. 50 characters (max. 100 characters across all bar codes per reading interval)		
Print ratio	2:1 ... 3:1		
No. of multiple reads	1 ... 99		
Optical indicators	4 x LEDs (status indicators)		
Acoustic indicator	Beeper, can be deactivated and assigned to a function for result status indication		
Reading pulse	Reflector polling/"Sensor 1" switching input/free running/serial interface		
"Host" data interface	RS 232 or RS 422/485, variable data output format		
Data transfer rate	300 ... 57 600 Bd		
Protocols	SICK Standard and 3964 (R)		
Physical configurations	Stand-alone		
"CAN" data interface	CANopen protocol, CAN Scanner Network		
Data transfer rate	20 KBits/s ... 1 MBits/s		
"Terminal" data interface	RS 232, 9 600 Bd, 8 data bits, no parity, 1 stop bit, fixed output format		
Switching inputs	2 ("Sensor 1", "Sensor 2")		
Switching outputs	2 ("Result 1", "Result 2")		
Electrical connection	15-pin D Sub HD connector, cable length 0.9 m		
Operating voltage/power consumption	10 ... 30 V DC*/3.5 W		
Housing	Cast zinc die-cast, does not represent a problem in paint shops		
Enclosure rating/protection class	IP 65 (to DIN 40 050)/Class 3 (to VDE 0106/IEC 1010-1)		
EMC/vibration/shock tested	to EN 61000-6-2, EN 55011/to IEC 68-2-6 Test FC/to IEC 68-2-27 Test EA		
Weight	250 g with connecting cable (front reading window)		
Operating/storage temperature	0 ... + 40 °C/- 20 ... + 70 °C		
Max. rel. humidity	90 %, non condensing		

*) UL certificated when a class 2 power supply according to UL 1310 is used



SICK AG
Auto Ident
Nimburger Strasse 11
79276 Reute
Germany
www.sick.com

Australia

Phone +61 3 94 97 41 00
1800 33 48 02 – toll free
Fax +61 3 94 97 11 87

Austria

Phone +43 22 36 62 28 80
Fax +43 22 36 62 28 85

Belgium/Luxembourg

Phone +32 24 66 55 66
Fax +32 24 63 31 04

Brazil

Phone +55 11 5091-4900
Fax +55 11 55 35 41 53

China

Phone +852 27 63 69 66
Fax +852 27 63 63 11

Czech Republic

Phone +42 02 57 81 05 61
Fax +42 02 57 81 05 59

Denmark

Phone +45 45 82 64 00
Fax +45 45 82 64 01

Finland

Phone +358-9-25 15 800
Fax +358-9-25 15 8055

France

Phone +33 1 64 62 35 00
Fax +33 1 64 62 35 77

Germany

Phone +49 211 5301-0
Fax +49 211 5301-100

Great Britain

Phone +44 1727 83 11 21
Fax +44 1727 85 67 67

Italy

Phone +39 02 27 40 93 19
Fax +39 02 27 40 90 87

Japan

Phone +81 3 33 58 13 41
Fax +81 3 33 58 90 48

Korea

Phone +82 2786 6321/4
Fax +82 2786 63 25

Netherlands

Phone +31 3 02 29 25 44
Fax +31 3 02 29 39 94

Norway

Phone +47 67 81 50 00
Fax +47 67 81 50 01

Poland

Phone +48 2 28 37 40 50
Fax +48 2 28 37 43 88

Singapore

Phone +65 67 44 37 32
Fax +65 68 41 77 47

Spain

Phone +34 9 34 80 31 00
Fax +34 9 34 73 44 69

Sweden

Phone +46 86 80 64 50
Fax +46 87 10 18 75

Switzerland

Phone +41 4 16 19 29 39
Fax +41 4 16 19 29 21

Taiwan

Phone +886 2 23 65 62 92
Fax +886 2 23 68 73 97

USA/Canada/Mexico

Phone +1 (952) 941-6780
Fax +1 (952) 941-9287

Branch offices and representatives
in all major industrial countries.

Received from your SICK partner: